

# LIGHT WEIGHT PLASTERBOARD ACCESS PANEL

## Installation Guide

1. Mark outline of aperture for access panel on ceiling lining.



2. Cut out plasterboard lining to form aperture by using a plasterboard saw.



3. Wipe edges of opening clean to receive access panel



4. Place access panel onto opening by fitting it diagonally through the opening and allow frame to sit on the edge of the opening

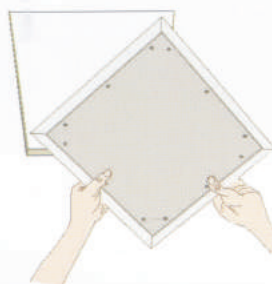

5. Access panel in position and ready to be fixed.



6. Open door panel by pushing up hinged side and slide outwards. Door will drop down. For larger panels (>450 mm), door will be secured by safety chain which needs to be unhooked for door to open completely.

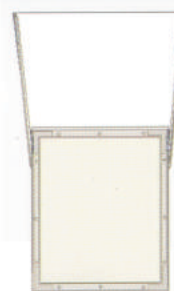

7. Grip and hold outer frame to ceiling lining and screw fixed from below through the ceiling lining to the outer frame. Screws should not be more than 300 mm apart. For large panels, additional bracings or support members may be required.

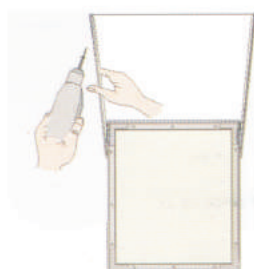

8. Screw holes shall be filled flush after fixing.



# LIGHT WEIGHT ALUMINIUM ACCESS PANEL (LWAP)

A low cost, lightweight access panel with minimum requirement. Access panel is opened by pushing up the cover and slide sideways above the ceiling.

For application in damp environment, moisture resistant plasterboard can be used in place of regular plasterboard for cover.

Framing are all aluminum an natural finish. Panel is supplied unpainted and will required sealing of screw heads and painting to match ceiling.

Installation is easy and aperture for access panel is cut to fit outer frame and fixing can be done by using standard plasterboard screws fixed from below through ceiling lining into outer frame.

## PANEL DESCRIPTION

<b>Application</b>	Ceilings
<b>Acoustic Rating</b>	None
<b>Profile</b>	25 mm deep x 1.0 mm thick aluminium in natural finish
<b>Panel Door</b>	9.5 mm thick standard plasterboard*
<b>Trim</b>	None (finished to flush with ceiling lining)
<b>Locks</b>	None
<b>Hinges</b>	None
<b>Finish</b>	Unpainted plasterboard finish
<b>Standard Sizes**</b>	300 mm x 300mm; 450mm x 450mm; 600 mm x 600 mm
<b>Pack Size</b>	50 panels per pallet

\* Moisture resistance plasterboard cover also available

\*\* Other sizes made to order

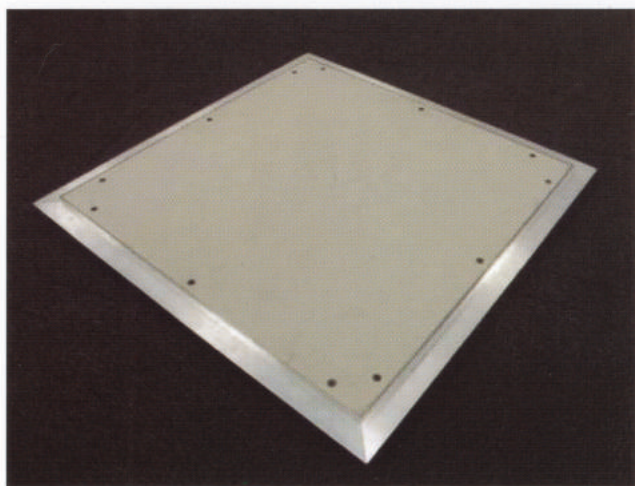

ACCESS PANEL – Front View



ACCESS PANEL – Aluminium framing

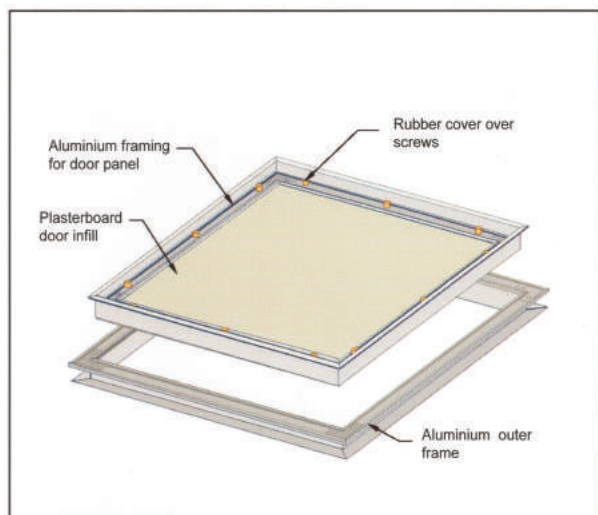

ACCESS PANEL – Push up and slide panel

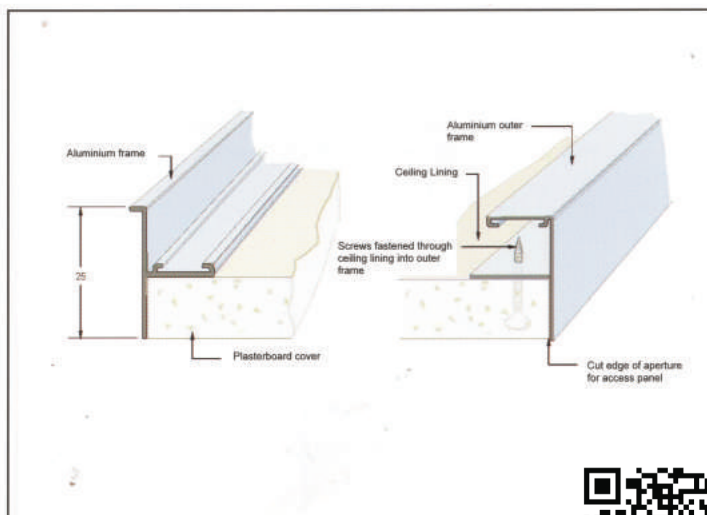

ACCESS PANEL – Framing profiles



SCAN & EMAIL ME